



SERVICE PARTS LIST

BUL. 54-08-0151

1/4" ELECTRIC DRILL

REVISED BUL. 611-4 DATE July '68

Catalog No. 0620

Starting Serial No. 11-3101

WIRING INSTR. 58-01-0180

Both Model and Serial No. must be furnished to obtain correct parts.

230V MOTOR

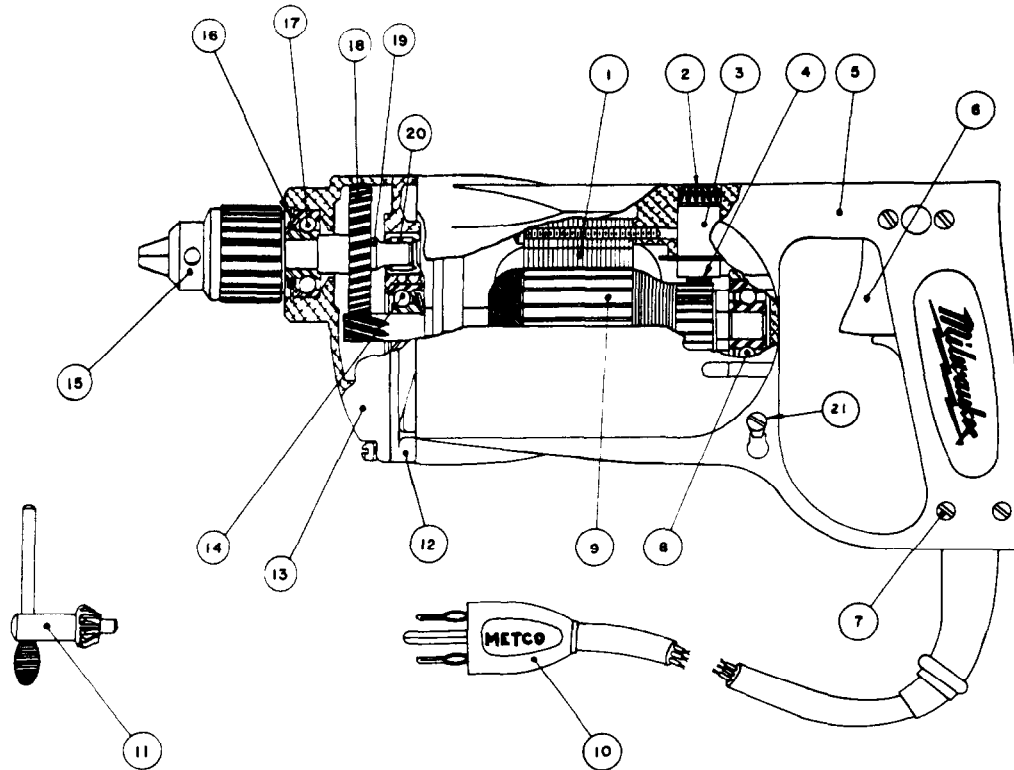

ILLUSTRATED PARTS

FIG.	PART NO.	DESCRIPTION OF PART	FIG.	PART NO.	DESCRIPTION OF PART	
1	18-42-1040	Field Assembly	12	28-28-0821	Diaphragm	
2	23-44-0060	Carbon Brush Ret. Scr.	(2)	13	28-14-0841	Gear Case
3	22-22-0080	Brush Holder Assembly	(2)	★14	02-04-0970	Ball Bearing (Pinion end)
4	22-18-0100	Carbon Brush Assembly	(2)	15	48-66-0260	Chuck
5	28-50-4682	Motor Housing		16	34-80-2200	Retaining Ring
6	23-66-0230	Switch		17	02-04-1060	Ball Bearing
7	45-04-0100	Cord Ret. Screw	(2)	18	32-75-1721	Spindle Gear
8	02-04-0970	Ball Bearing (comm. end)		19	38-50-3151	Spindle
9	16-42-1090	Armature Assy.		20	02-50-2110	Needle Bearing
10	22-64-0180	Cord Set		21	42-70-0080	Key Clip
11	48-66-3200	Chuck Key				

MISCELLANEOUS PARTS (NOT SHOWN)

PART NO.	DESCRIPTION OF PART	PART NO.	DESCRIPTION OF PART
06-81-8650	6-32 1/4 Rd. Hd. Key Clip Scr.	★06-42-0800	Woodruff Keys
06-81-8625	6-32x1/4 Rd. Hd. (Brass) Ground Scr.	★06-81-8400	4-40x1/4 Rd. Hd. Name Plate Scr. (2)
06-81-6300	8-32x7/8 Fil. Hd. Gear Case Scr. (2)	12-98-0500	Name Plate
06-81-6500	8-32x1-3/8 Fil. Hd. Gear Case Scr. (2)	06-81-8650	6-32x1/4 Rd. Hd. Switch Bracket Scr. (2)
06-81-6650	8-32x1-3/4 Fil. Hd. Field Scr. (2)	06-81-3400	6-32x1/4 Oval Hd. Switch Locating Scr. (2)
06-65-0825	1/8x1/2 Type 5 Groove Pin	42-36-0170	Switch Bracket
23-86-0110	Insulating Washer (2)	06-83-2670	1/4-20x1/2 Brush Holder Set Scr. (4)
★06-97-1800	Lock Washer	★48-03-0010	Plug Adapter
★23-16-0390	Switch Insulator		