



# SERVICE PARTS LIST

BUL. 54-06-3201

1/4" PISTOL DRILL

REVISED BUL 682-2 DATE Feb. '68

Catalog No. 0310

Starting Serial No. 82-1185

WIRING INSTR. 58-01-0020

Both Model and Serial No. must be furnished to obtain correct parts.

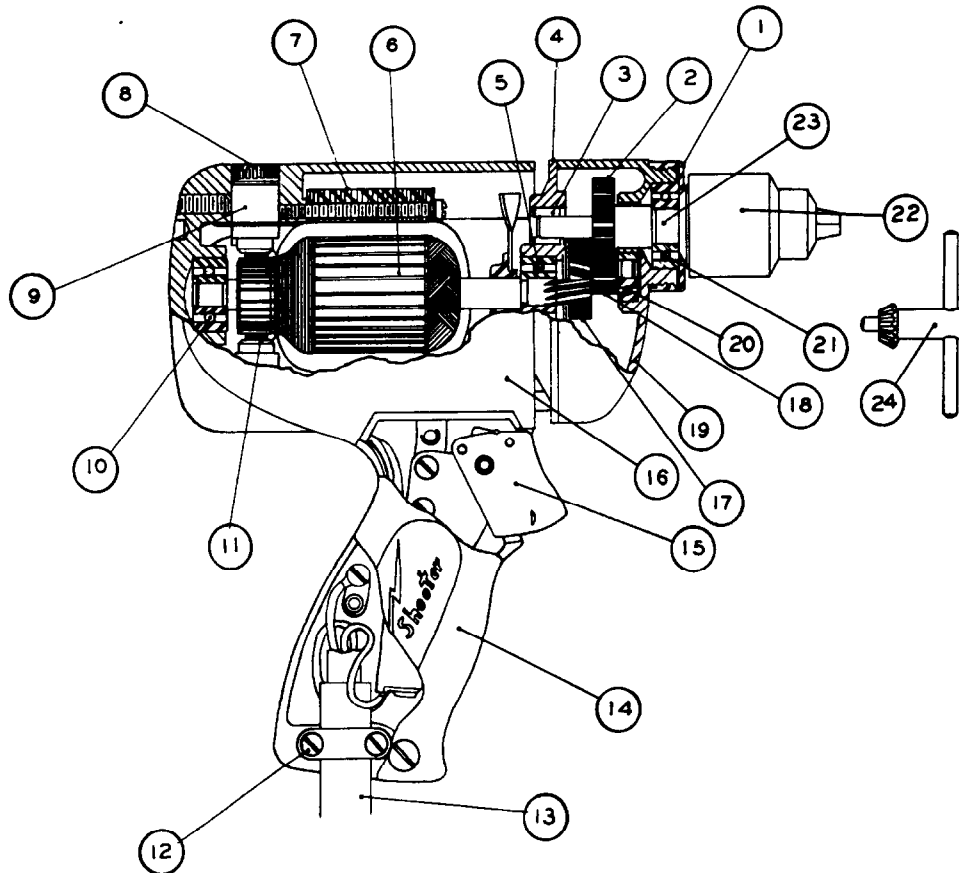

ILLUSTRATED PARTS

FIG.	PART NO.	DESCRIPTION OF PART
1	42-52-0060	Bearing Cap
2	32-75-1341	Spindle with Gear
3	02-50-1640	Needle Bearing
4	28-28-0221	Diaphragm
5	02-04-0880	Ball Bearing (Pinion End)
6	16-22-1120	Armature Assembly
7	18-22-1030	Field Assembly
8	23-44-0020	Brush Retaining Cap
9	22-22-0050	Brush Holder Assembly
10	02-04-0740	Ball Bearing
11	22-18-0090	Carbon Brush Assemblies
12	28-17-0400	Cord Clamp
*13	22-64-0170	Cord Set

MISCELLANEOUS PARTS NOT SHOWN

PART NO.	DESCRIPTION OF PART
48-66-4080	Rubber Flex Chuck Key Holder
44-66-0110	Air Intake Cover Plates (2)
06-81-8650	6-32x1/4" Rd. Hd. Sems Ventilating Plate Scs. (4)
12-98-0600	Name Plate
06-81-4300	3-48x3/16" Rd. Hd. Name Plate Screws (2)
*06-81-0900	8-32x7/16" Fil. Hd. Cord Clamp Screw
06-81-6100	8-32x7/16" Fil. Hd. Cord Clamp Screws Sems
48-03-0010	Attachment Plug Adaptor
02-50-1210	Needle Bearing
*06-97-1800	Switch Lock Washer (4)

FIG.	PART NO.	DESCRIPTION OF PART
14	28-20-3171	Switch Cover Plate
15	23-66-0270	Switch
*16	28-50-4601	Motor Housing (Incl. item 14 & scrs.)
17	32-40-1041	Intermediate Gear
18	36-66-1451	Pinion Shaft
19	28-14-0361	Gear Case
20	02-04-0640	Ball Bearing
21	02-04-1020	Ball Bearing
22	48-66-0260	Chuck
23		See Item 2
24	48-66-3200	Chuck Key

PART NO.	DESCRIPTION OF PART
06-83-2670	1/4"-20x1/2" Hd'less Slotted Brush Holder Set Scs. (2)
06-81-8625	6-32x1/4" Brass Rd. Hd. Ground Screw Sems
06-81-6550	8-32x1 1/2" Fil. Hd. Gear Case Screws Sems (2)
06-81-6300	8-32x7/8" Fil. Hd. Gear Case Screws Sems (2)
06-81-5950	6-32x1-7/8" Fil. Hd. Field Screws Sems (2)
06-81-5400	8-32x5/16" Binder Hd. Switch Mounting Screws (2)
06-81-3700	8-32x7/8" Oval Hd. Handle Cover Screws
06-81-3650	8-32x3/4" Oval Hd. Handle Cover Screw Top (2)
06-42-0400	Woodruff Key (Pinion Shaft)