



SERVICE PARTS LIST

BULLETIN NO.
54-06-0153

SPECIFY CATALOG NO. AND SERIAL NO. WHEN ORDERING PARTS		REVISED BULLETIN 54-06-0152	DATE June '80
1/2" MAGNUM HOLE-SHOOTER			
CATALOG NO. 0234-1	STARTING SERIAL NO. 532-100500	WIRING INSTRUCTION 58-01-0072	

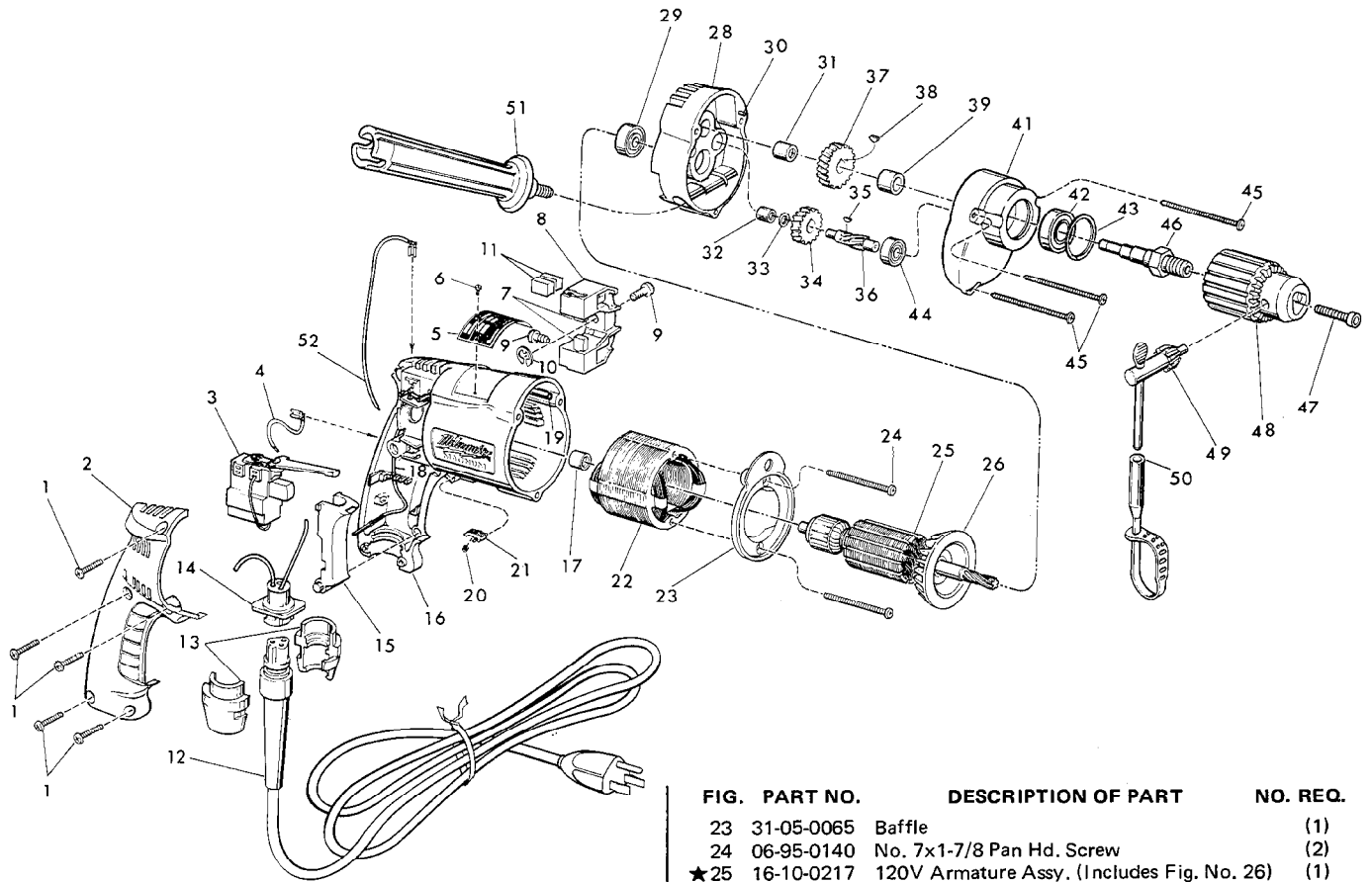

FIG.	PART NO.	DESCRIPTION OF PART	NO. REQ.
	1	06-95-0220 8-18x3/4 Pan Hd. Thread Form Screw	(5)
	2	31-15-0101 Handle Cover	(1)
★	3	23-66-0981 Trigger Speed Control Reversing Switch	(1)
	4	23-94-9625 2-1/4 Lead Assembly	(1)
	5	12-99-0071 Nameplate Blank	(1)
	6	06-85-0200 Nameplate Screw	(2)
	7	22-16-0270 Carbon Brush	(2)
	8	22-22-0350 Brush Holder Assy. (Includes Fig. Nos. 9 thru 11)	(1)
	9	31-75-0010 Brush Holder Screw	(2)
	10	34-60-0500 1/4" Ext. Retaining Ring	(1)
	11	22-16-0270 Carbon Brush (Spares)	(2)
	12	48-76-3008 Cord Set (Includes Fig. No. 13)	(1)
	13	44-40-0440 Cord Nut	(2)
★	14	22-56-0302 Pin Housing Assembly	(1)
	15	45-72-0080 Trigger	(1)
★	16	14-38-0325 Motor Housing Assy. (Includes Fig. Nos. 17 thru 19)	(1)
	17	02-50-2025 Sealed Needle Thrust Bearing	(1)
★	18	23-94-9686 Ground Wire Assembly	(1)
★	19	44-60-0570 Grounding Pin	(1)
	20	40-50-0085 Lock Button Spring	(1)
	21	42-42-0150 Lock Button	(1)
★	22	18-10-0045 120V Field	(1)

FIG.	PART NO.	DESCRIPTION OF PART	NO. REQ.
	23	31-05-0065 Baffle	(1)
	24	06-95-0140 No. 7x1-7/8 Pan Hd. Screw	(2)
★	25	16-10-0217 120V Armature Assy. (Includes Fig. No. 26)	(1)
	26	22-84-0650 Fan Assembly	(1)
★	27	14-13-0350 Diaphragm Assy. (Fig. Nos. 28 thru 32)	(1)
★	28	28-28-1570 Diaphragm	(1)
★	29	02-04-0847 Ball Bearing	(1)
★	30	06-65-0825 1/8x1/2 Groove Pin No. 5	(1)
★	31	02-50-2020 Needle Bearing	(1)
★	32	02-50-1620 Needle Bearing	(1)
★	33	45-88-7721 Heat Treated Washer	(1)
★	34	32-40-1810 Intermediate Gear	(1)
	35	06-42-0400 Woodruff Key	(1)
★	36	36-66-4260 Intermediate Pinion	(1)
★	37	32-75-2910 Spindle Gear	(1)
★	38	06-42-1200 Woodruff Key	(1)
★	39	45-36-1100 Spacer	(1)
★	40	14-30-0330 Gear Case Assy. (Fig. Nos. 41 thru 44)	(1)
★	41	28-14-1440 Gear Case	(1)
★	42	02-04-1230 Ball Bearing	(1)
★	43	34-80-2300 Retaining Ring	(1)
★	44	02-04-0640 Ball Bearing	(1)
★	45	06-95-0150 No. 7x2-3/16" Pan Hd. Screw	(3)
★	46	38-50-5250 Spindle - Double Reduction	(1)
	47	06-75-3150 1/4-20x1" Socket Hd. Screw - L.H. Thread	(1)
	48	48-66-1360 1/2" Chuck (Includes Fig. No. 49)	(1)
	49	48-66-3280 Chuck Key	(1)
	50	48-66-4040 Key Holder	(1)
★	51	43-62-0555 Side Handle	(1)
★	52	23-94-9630 7" Lead Assembly	(1)
★	53	10-98-5945 Caution Label (Not Shown)	(1)
★	54	10-98-5986 Warning Label (Not Shown)	(1)